



Water quality testing

pH-703

Portable pH Meter

English Manual



CE

In order to let you have a better experience, please read this manual carefully before using the instrument again, and please pay attention to the instructions on the "Precautions" and "Warning" slogans to avoid inaccurate measurements and misoperations that damage the life of the instrument .

pH-703



Before using the product, please be sure to understand that if the instrument measures strong acid (below pH 4) or strong alkali (above pH 10) liquid, the service life of the instrument will be greatly shortened, and it will cause direct damage to the electrode head and make it impossible to measure.



This product is designed for general water quality measurement and is not suitable for measuring chemical raw materials, special solvents and other liquids. The sensing electrode may be damaged by such liquids or cause large errors.



Please keep the KCL liquid in the electrode protective sleeve, and do not fill it with general tap water or mountain spring water.



The accuracy of the instrument will increase due to factors such as battery power attenuation and electrode aging. If you need more accurate measurement, it is recommended to use pH7 calibration liquid to calibrate before each measurement to confirm whether the error is within the specification. Measurement is performed after the test is performed. For detailed calibration methods, please refer to the calibration operation instructions in the manual.



Do not measure anything with strong stickiness, such as glue, ink and other liquids, because the sensor head of this instrument is very fragile, if it is slightly pressed or knocked, it may cause damage to the hard head.

warn



Please place the instrument in a place that is difficult for children to take, so as to prevent children from eating or damaging the instrument by mistake.



If the KCL liquid or pH7 calibration liquid accidentally touches the eyes, mouth, etc., please rinse with plenty of water! If you still feel uncomfortable after washing, please send to the doctor immediately and take the accidentally contacted liquid to the hospital.



Under no circumstances should this instrument be in direct contact with food or drinking water, etc. Please use a measuring cup to scoop up a sufficient amount of liquid, and then insert the instrument into the measuring cup to measure.

Product Specifications:

| | |
|--------------------------|--|
| Measuring Range: | 0.00 ~ 14.00 pH 0.01 |
| Resolution: | pH \pm 0.02 |
| Error Value: | pH 0 ~ 50 \bar{y} |
| Temperature Compensation | 9V battery X |
| Range: Battery | 1 |
| Dimensions: Weight: | 6.2"x1.6"x1.3" (158x40x34 mm) 3.15 oz (90g) |
| | pH7 test solution X |
| Accessories: | 1, adjustment pen X 1 KCL replenisher X 1. 9V battery X 1 |

Instructions:

1. For the first use, please insert the battery and turn on the power. 2. Open the protective cover, then stretch the electrode, and then remove the latex protective cover of the electrode.

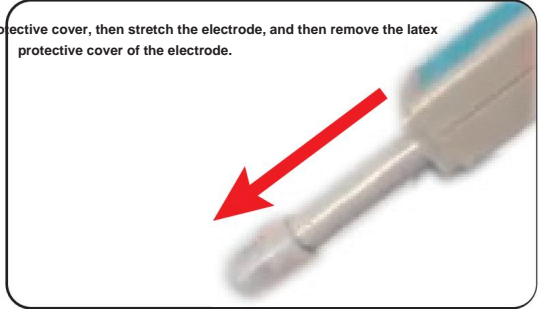

3. Use distilled water or pure water to clean the electrode head, try to avoid using general tap water or river clean water to clean the electrode head.



4. Pour an appropriate amount of pH 7 calibration solution into the measuring cup, the liquid height is enough to cover the front end of the electrode tip.

5. Insert the dried electrode into the measuring cup and wait for about 10 seconds for the value to stabilize.



6. If the measured value is not equal to 7.00, use the adjustment pen to fine-tune the adjustment knob on the right side of the instrument, so that the value on the screen is displayed as 7.00.



7. After the adjustment is completed, clean the sensor head again.

8. Start measuring the liquid to be tested.

Maintenance and maintenance:

If you do not use the instrument for a long time, please remove the battery, and make sure that there is enough KCL liquid in the latex protective case. Crystal particles will form after KCL is placed for a long time. This is normal, please don't worry.

The battery needs to be replaced regularly. If the battery power is low, the error of the measured value will increase.

When measuring any strong acid or strong alkali liquid, please clean the electrode tip and wipe the instrument with a neutral liquid. Do not use it in liquid with strong adhesion, such as ink. Because the electrode tip is quite fragile, it is not suitable for contact. Touch clean and wipe with a cloth.

Product Warranty:

1. This product is guaranteed for one year from the date of purchase, but the aging of the electrode head and the use of related calibration fluids are not covered by the warranty.

2. If the invoice is lost or there is no certificate, the company will use the factory date of the manufacturing number
To calculate the warranty period.

3. Guarantee content:

(1) The free service period is one year: under normal use within one year from the date of purchase, if the product fails, free service and replacement parts will be provided. However, man-made (such as external force damage, used for measurement outside the specification), natural disasters and earth-changing damages are not subject to this limitation (if service is required to replace parts, the parts fee will be charged according to the price specified by the company).

(2) The chargeable service period is one year: within one year after the free service period is exceeded, if the product fails to be repaired and replaced with parts, the parts fee will be charged according to the price stipulated by the company, and the service fee will be charged as appropriate.

(3) If the product has been used for more than the above two years, if it fails and the company still has parts, it will provide service, but the service fee will be charged in addition to the parts fee. If the company has no parts, it will be difficult to service.

TECPHEL

Service information:

Dealer: _____